

Terrco[®], Inc.

Terrco Edger



OPERATING INSTRUCTIONS

MAINTENANCE INSTRUCTIONS

ILLUSTRATED PARTS LIST

Terrco[®], Inc.

222 1st Avenue NW • Watertown, SD 57201

Phone: (605) 882-3888 • Fax: (605) 882-0778 • Email: info@terrco.com

EDGER SPECIFICATIONS

1. MOTOR: 3 HP, 230 Volt, 60 Hz
2. STARTER: 1 Phase, Magnetic Starter
3. Movable Arm
4. TRUCK WHEELS: Roller bearing, rubber tired
5. SPEED OF GRINDING WHEEL: 1760 RPM
6. Dry Set-Up Only
7. LUBRICATION: Wheel bearings only
8. WEIGHT: 230 LB—106 kg
9. SHIPPING WEIGHT: 315 lb—144 kg
10. ABRASIVE PRESSURE ON STONE: 45 lb
11. LENGTH: 37-1/2 inches
12. WIDTH: 16 inches
13. HEIGHT: 37-1.2 inches
14. ADJSUATBLE CARRIAGE: Carriage adjusts to keep machine level at all times.

OPERATING INSTRUCTIONS:

TO INSTALL/REMOVE GRINDING WHEEL:

1. Disconnect power to the machine.
2. Tip machine back on the rear carrying handle.
3. Use the wrenches to remove the grinding wheel.
4. Clean the machine prior to installing a new grinding wheel
5. Install new grinding wheel.
6. Adjust guard.
7. Tip machine down to operating position.
8. Adjust carriage height to set grinding wheel square to the floor.

TO START/STOP MACHINE:

1. Connect power to the machine. The Terrco Edger will operate most efficiently within the voltage range of 215-230 volts. Number 14-3 rubber cable is the minimum size cable to be used with this machine, if adding cable after the first 100 feet.
2. Lift some of the weight off of the grinding stone and push the start button.
3. To stop the machine, push the stop button.

SAFETY:

1. Have an electrician hook up power to machine.
2. Always operate machine with ground faults at the electrical source.
3. Always wear appropriate safety protection. Eye, hearing and respiratory protection is advised.
4. Rotating grinding wheels can cause injury, keep hands and loose clothing clear.
5. Service and adjust guard for maximum protection, never remove it.
6. Keep machine clean and serviced.

REPAIRS:

1. Use only Terrco® parts.
2. When ordering parts, have model number, serial number and part numbers.
3. For factory repairs, send the machine to Terrco®, freight pre-paid, with a letter stating problem, name and phone number.

WARRANTY CLAIM PROCEDURE

Each new machine is covered by two separate, distinct warranties—one on the machine and one on the electric motor of gasoline engine. Read **VERY CAREFULLY** the Terrco[®] warranty covering the machine, as this will tell you whether you have a warranty claim or not. If your machine is under warranty and malfunctions, determine whether your problem is electrical or mechanical, and do the following:

I. Electrical.

- A. Consult the list of authorized motor repair stations sent with the machine and locate the station nearest you.
- B. Contact the repair station, giving them the following information:
 - 1. Complete nameplate data from the motor.
 - 2. Tell them that the machine is a terrazzo grinding and polishing machine.
 - 3. Give them a description or rundown of the trouble.
 - 4. Inform them of the voltage and amperage readings as outlined in paragraph II, B, 2 and 3, on page 2 of this manual.

II. Mechanical

- A. Contact your Terrco[®] Distributor giving them the following:
 - 1. Model and date purchased.
 - 2. Horsepower.
 - 3. Accurate description of the malfunction.
- B. If there is no Terrco[®] Distributor in your area call or write to us with the above information.

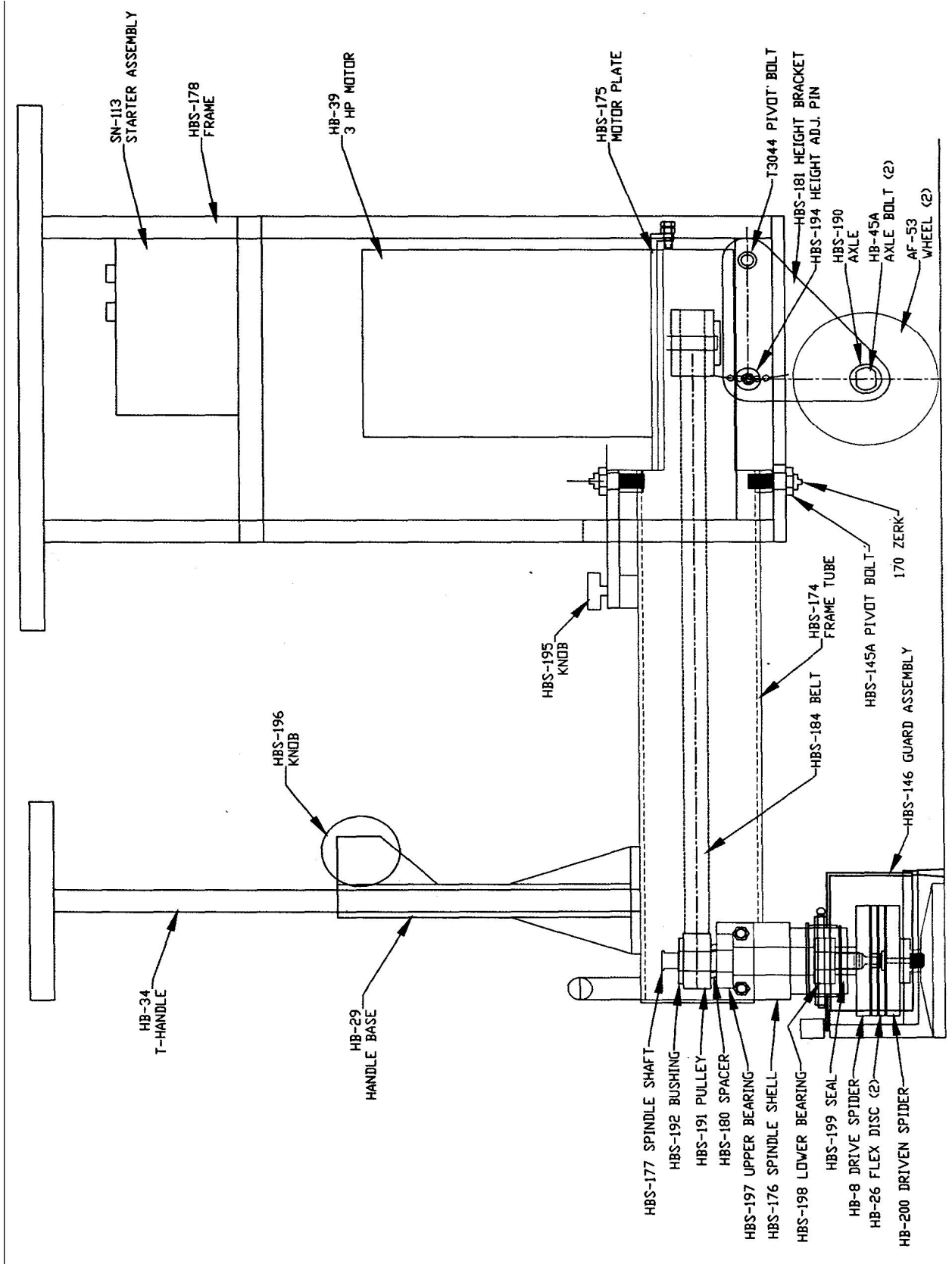

LIMITED ONE YEAR WARRANTY

TERRCO[®], Inc. warrants the original purchaser of the Terrco[®] grinding equipment to be free from defects in materials and workmanship under normal use and service. Our obligation under this warranty shall be limited to the repair or exchange of any part or parts which may prove defective under normal use and service within one year from date of purchase by, the original purchaser, and which our examination shall disclose to our satisfaction to be defective.

All equipment returned for repairs or exchange must be returned to: TERRCO[®], Inc., at the purchaser's expense and within the warranty period. All repaired or exchanged equipment will be shipped back to the purchaser F.O.B. Watertown, South Dakota.

THIS WARRANTY IS EXPRESSLY IN LIEU OF ALL OTHER WARRANTIES EXPRESSED OR IMPLIED INCLUDING THE WARRANTIES OR MERCHANTABILITY AND FITNESS FOR USE AND ALL OTHER OBLIGATIONS OR LIABILITIES ON THE PART OF TERRCO[®], INC. AND WE NEITHER ASSUME OR AUTHORIZE ANY OTHER PERSON TO ASSUME FOR US, ANY OTHER LIABILITY IN CONNECTION WITH THE SALE OF THIS EQUIPMENT. SOME STATES DO NOT ALLOW THE EXCLUSIONS OR LIMITATIONS ON IMPLIED WARRANTIES OR DO NOT ALLOW THE EXCLUSION OF LIMITATION OF INCIDENTAL OR CONSEQUENTIAL DAMAGES, SO THE ABOVE EXCLUSIONS OR LIMITATIONS MAY NOT APPLY TO YOU. THIS WARRANTY SHALL NOT APPLY TO ANY EQUIPMENT OR PART THEREOF WHICH HAS BEEN SUBJECT TO ACCIDENT, NEGLIGENCE, ALTERATIONS, ABUSE, MISUSE, OR IMPROPER MAINTENANCE. TERRCO[®], INC. MAKES NO WARRANTIES WHATSOEVER IN RESPECT TO ACCESSORIES OR PARTS NOT MANUFACTURED OR SUPPLIED BY US.